

Inset 1
Scale 1:250

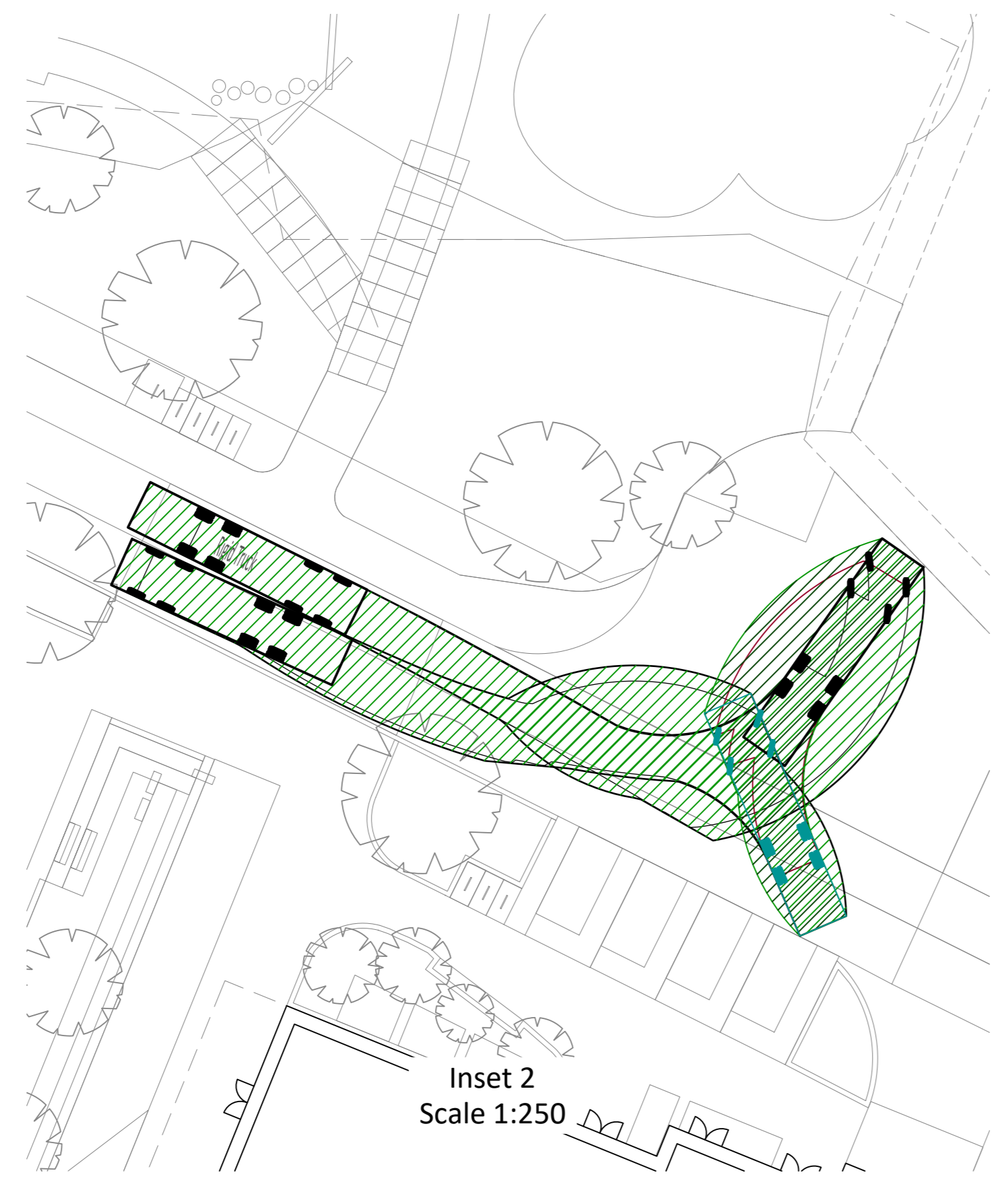

Inset 2
Scale 1:250

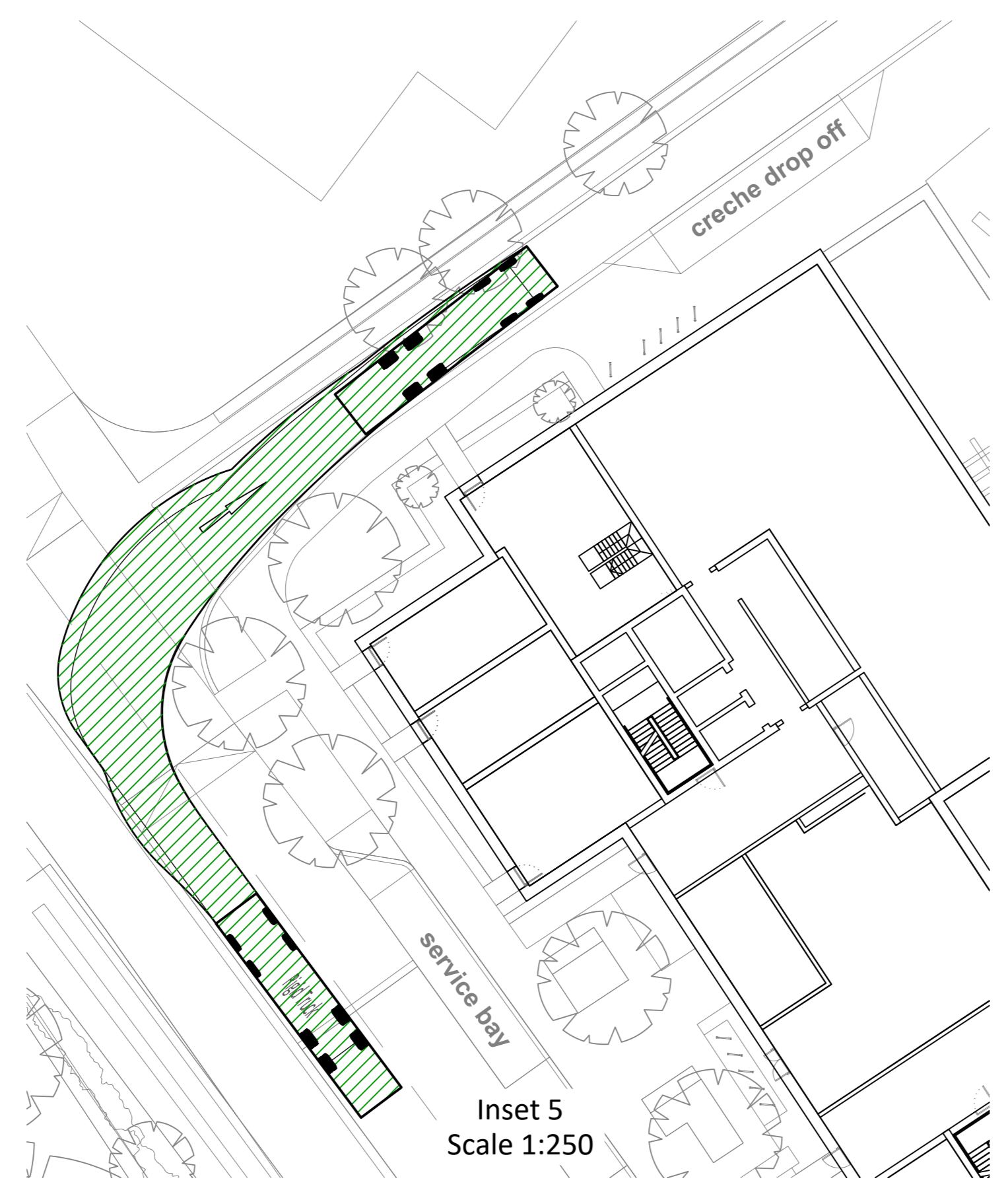

Inset 5
Scale 1:250

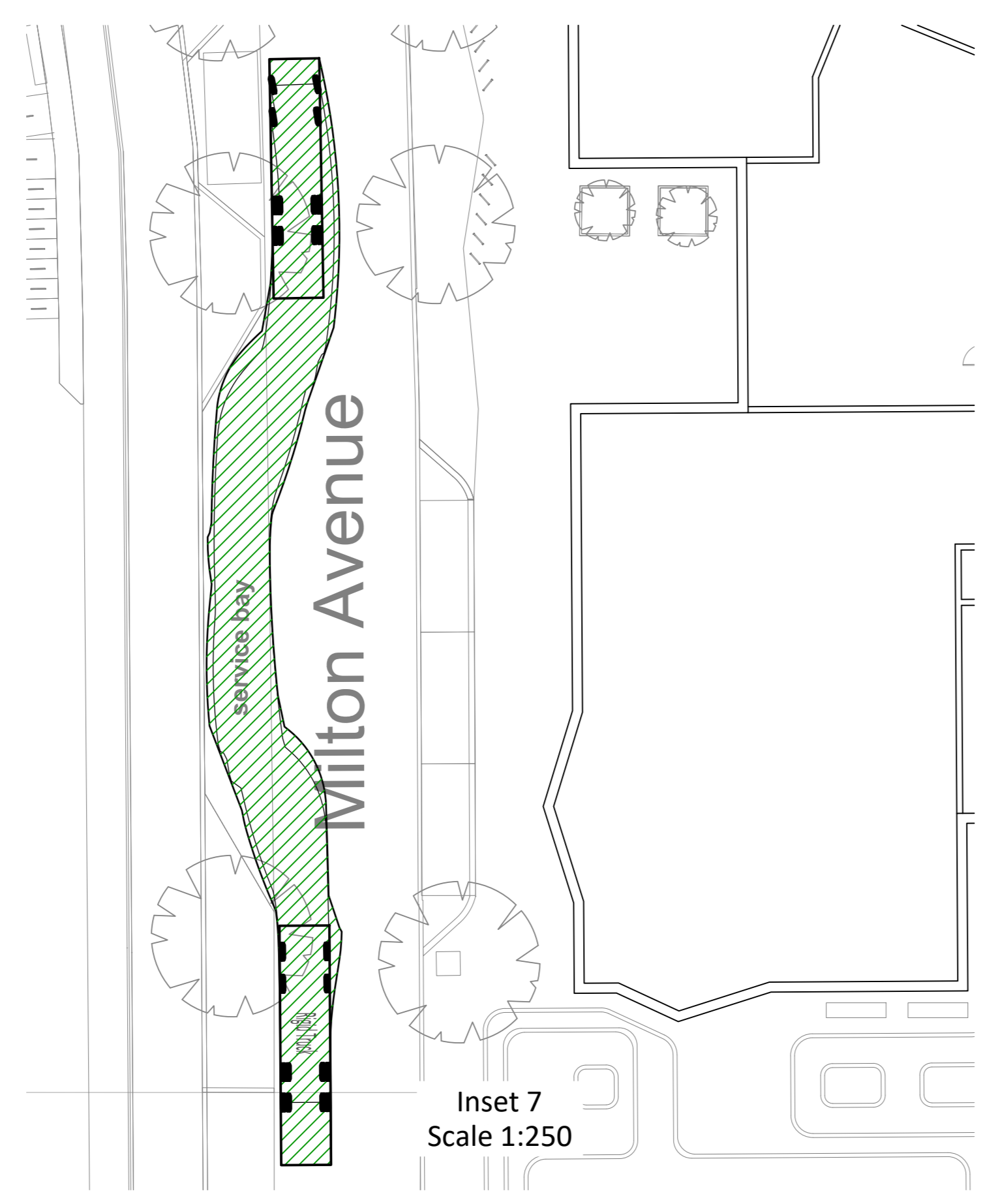

Inset 7
Scale 1:250

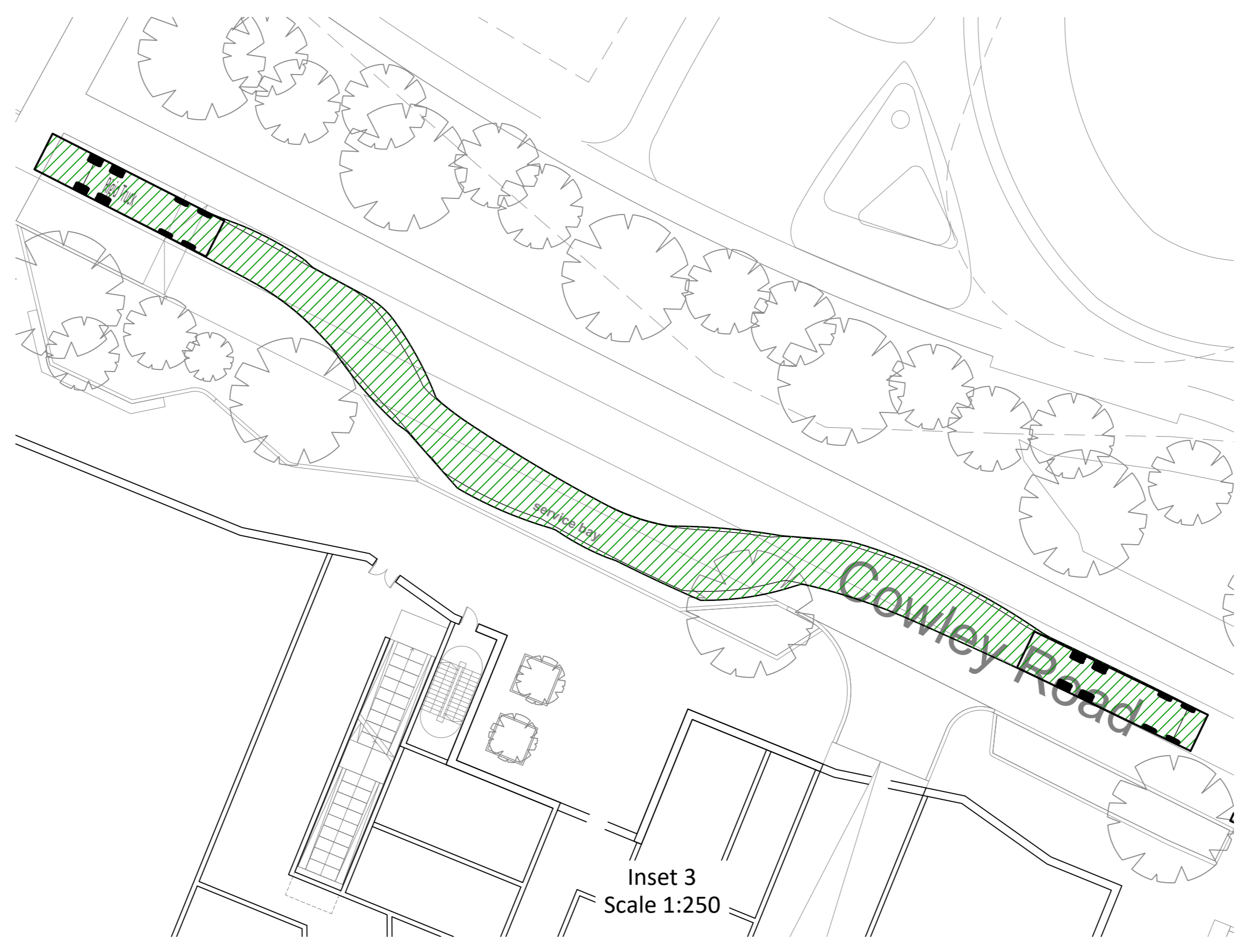

Inset 3
Scale 1:250

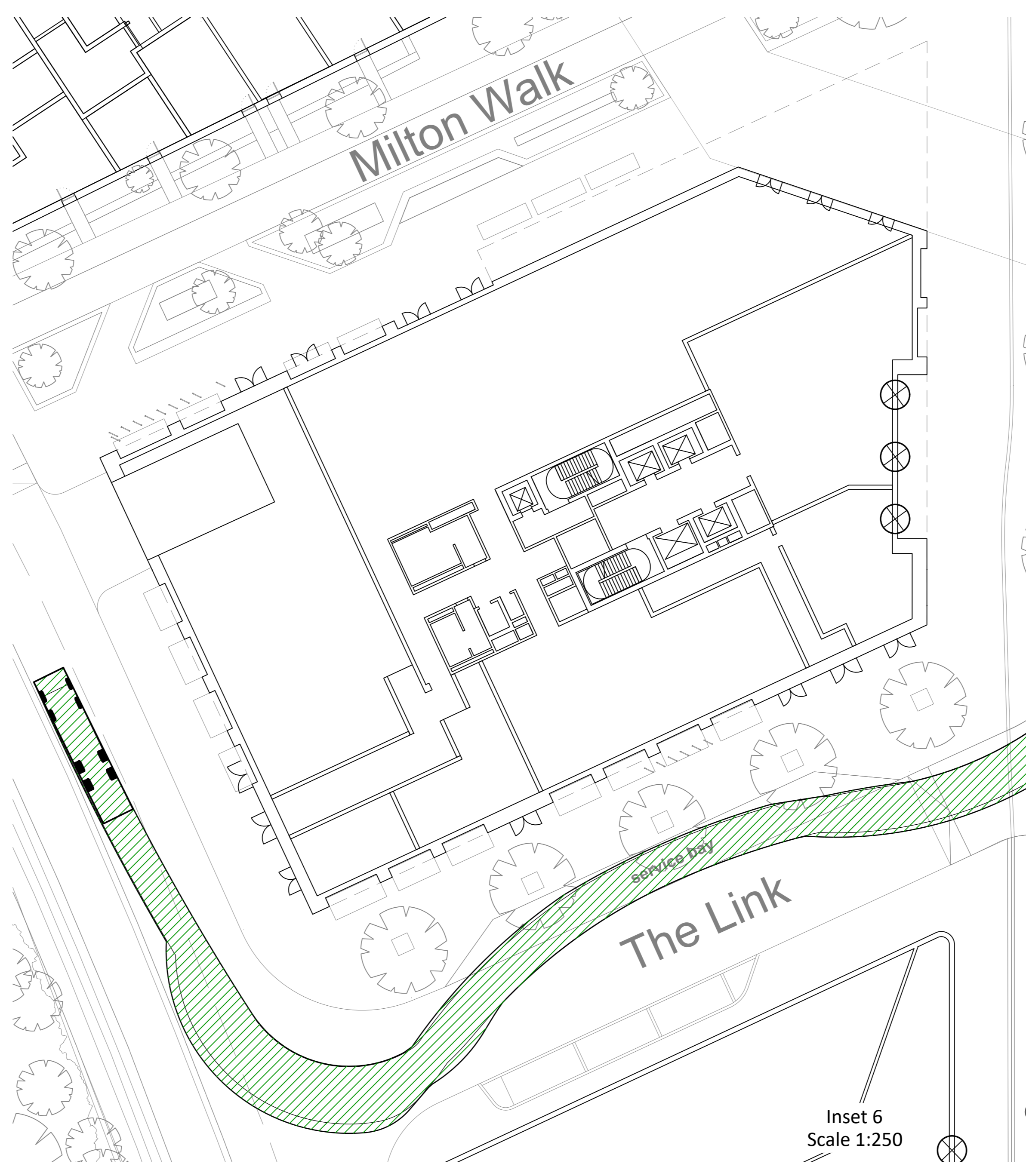

Inset 6
Scale 1:250

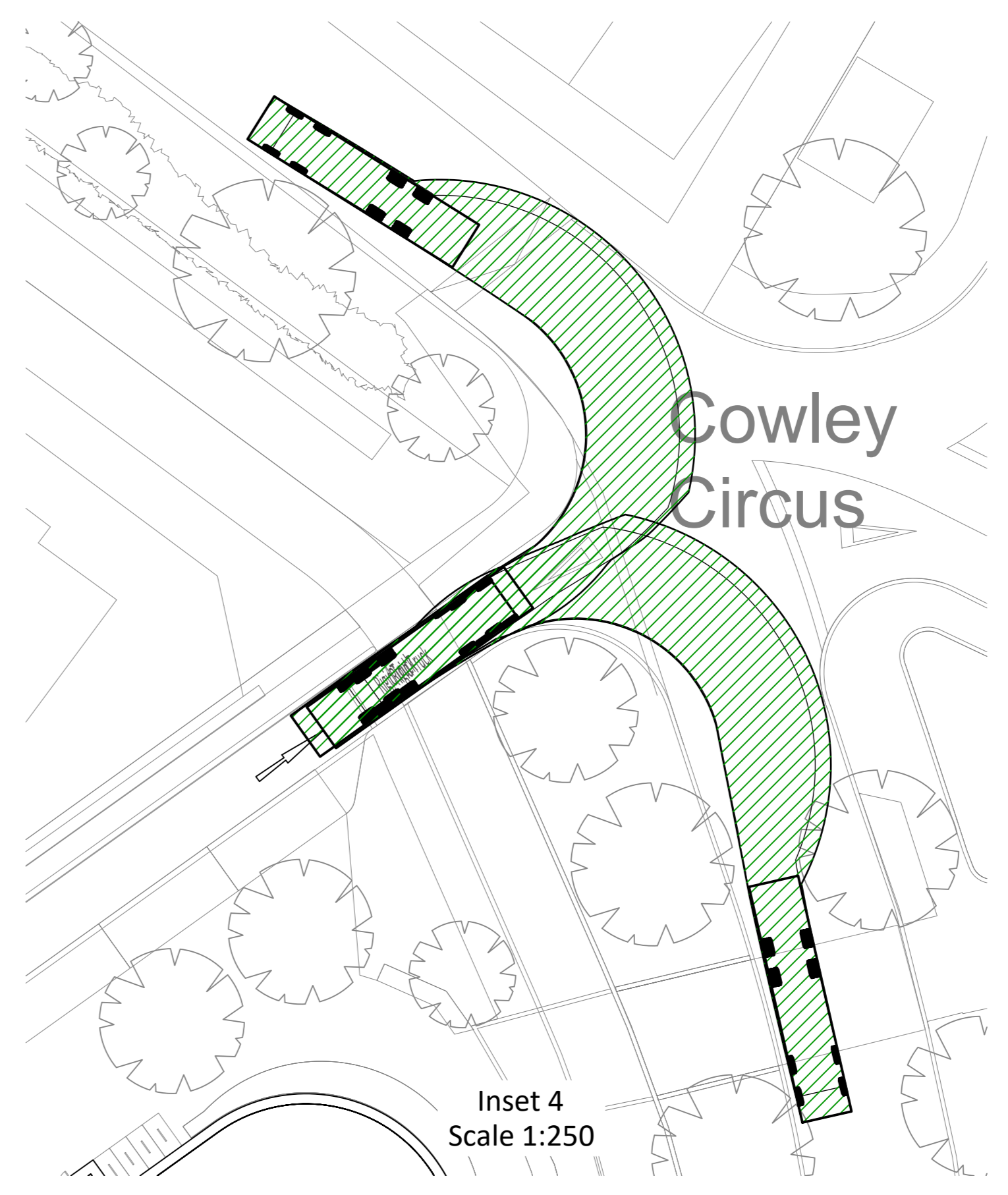

Inset 4
Scale 1:250

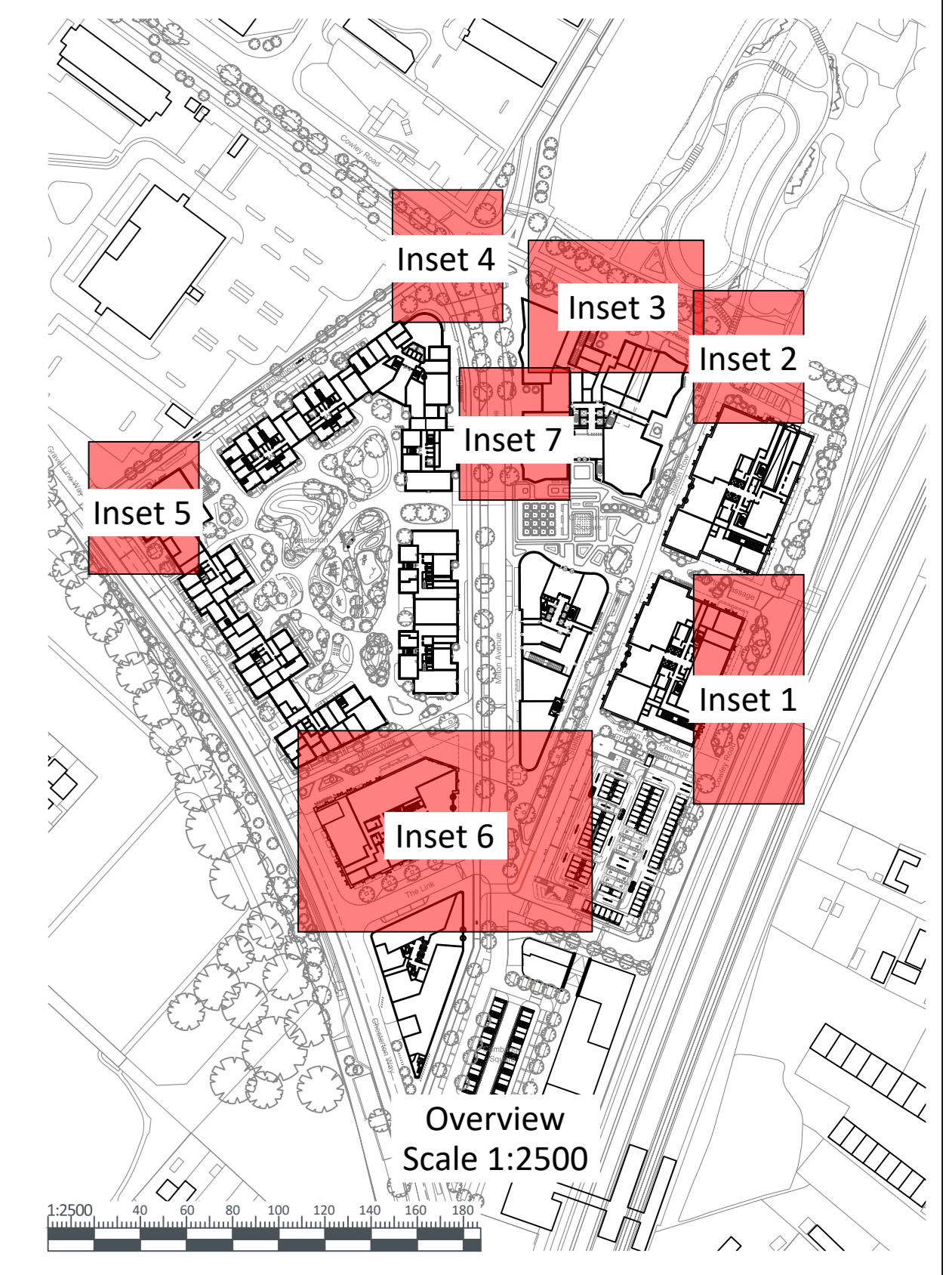

Overview
Scale 1:2500

NOTES
These drawings have been produced with reference to the CDM Regulations 2015. Please note that these are pre-construction phase drawings and should be subject to further design risk management as required in accordance with Regulation 9.

- These drawings have been produced with reference to the CDM Regulations 2015. Please note that these are pre-construction phase drawings and should be subject to further design risk management as required in accordance with Regulation 9.
- All dimensions in metres unless stated otherwise.
- This drawing is based on 'Make drawing 239ACAE-PLT-PROPOSED-1:2000-01-PLANNING, with Make' received 07/10/2021.
- The purpose of this drawing is to show the location of the proposed service road on cross sections of the existing ground.
- Levels information based on topographical survey data in Survey Solutions drawing 20252ea Rev A dated 19/01/2018.

- GENERAL NOTES**
- This drawing is to be read in conjunction with all other relevant Engineering and Architect's details.
 - The design details presented must be reviewed in conjunction with the wider site information and the constraints which may not be evident on drawing and must be requested if not already provided. This includes, but not limited to, ground conditions (geotechnical and geo-environmental), groundwater levels, buried services, remnant obstructions, ecology, tree protection and topography.
 - The Engineer shall be notified immediately, in writing, should any errors or discrepancies be found prior to the commencement or continuation of any works.
 - All work is to be carried out in accordance with current British Standards, Building Regulations and Historic Standards.
 - It is the responsibility of the Contractor to execute the works at all times in strict accordance with the requirements of the Health and Safety at Work Act 1974, and the CDM Regulations 2015. The Contractor will be deemed to have allowed for full compliance, including full liaison with the CDM Co-ordinator, within his rates.
 - Any existing details which are shown on this drawing are for guidance only and are to be checked on site by the contractor. Any variations are to be recorded and reported to the engineer immediately.
 - Before work commences contractor should consult the engineer and the SI report regarding any contamination issues. All necessary Health and Safety measures to be taken.

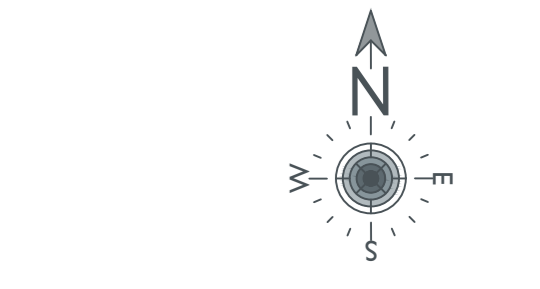

KEY

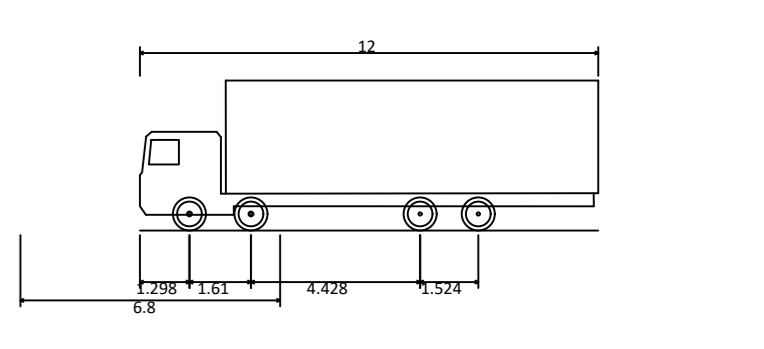

Rigid Truck	12,000m
Overall Length	2,500m
Overall Width	3,925m
Min Body Ground Clearance	0,412m
Track Width	2,471m
Lock to lock time	6,905m
Kerb to Kerb Turning Radius	11,900m

PI 25.02.21 Updated to latest layout, Milton Avenue tracking
REV DATE REVISIONS



Brookgate Ltd

PROJECT
Cambridge North

BOARDING TITLE
Rigid Truck
Vehicle Tracking

INFORMATION
05425 - C - 2206 - PI

SCALE	DESIGN	ENGINEER	DATE
A0@1:250	OB	GD	28.04.22