

NOTES

DO NOT SCALE FROM THIS DRAWING TO BE READ IN COLOUR  
 Contractors, sub-contractors and suppliers are to verify any critical dimensions on site prior to commencing work, fabrication or construction of any elements. Any discrepancies or errors must be brought to the attention of Robert Myers Associates.  
 All structural elements are shown indicatively. For all elements of structure, refer to structural engineers' and specialist sub-contractor/fabricators' design, detail and specification.  
 The drawings are to be read in conjunction with all relevant landscape architect, consultant and specialist drawings.  
 This drawing is to be read specifically in conjunction with:  
 630\_01(MP)001 Landscape Masterplan.

LOCATION PLAN

SCALE: NTS

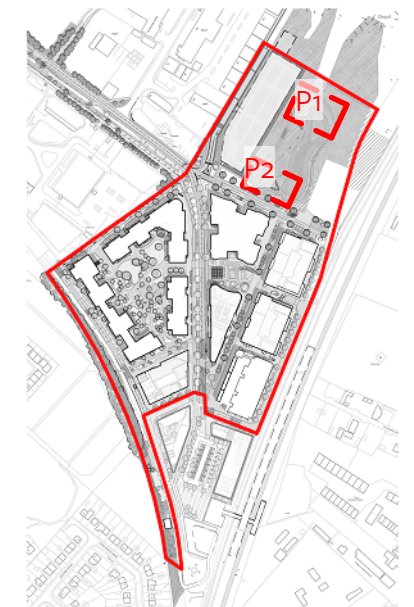

PURPOSE OF ISSUE

Rev:	Date:	Drawing Status:
P1	10.06.22	FOR PLANNING

REVISIONS

Rev:	Date:	Description:
P1	10.06.22	First Issue

CAMBRIDGE NORTH

Client:	Brookgate		
Drawing:	Play Areas - Wild Park		
Project No:	630_01		
Drawing No:	630_01(MP)306		
Scale:	1:250@A3	Rev:	P1
Date:	June 2022	Drawn:	EH
Checked:	JB	PM Checked:	RM

**Robert Myers Associates**  
 LANDSCAPE ARCHITECTURE



13-15 Covent Garden  
 Cambridge  
 CB1 2HS

Tel: +44 (0) 1223 351400

info@robertmyers-associates.co.uk  
 www.robertmyers-associates.co.uk

DO NOT SCALE FROM THIS DRAWING  
 © Robert Myers Associates



Timber bench seating

Timber board walk as play element: Add old train wheels and a 'sounding' surface, as interactive play

Interpretation board

Circular pedestrian recreational route around balancing pond, laid to Breedon gravel

Natural Play - fallen logs/stumps and timber play sculpture

Proposed Open Mosaic Habitat seeding

Existing Open Mosaic Habitat seeding

Existing vegetation to be retained

Natural Play - fallen logs/stumps and timber play sculpture

Coppiced willows to be transplanted from the south of the site

P-1 Typical Play Areas- Wild Park  
 Scale 1:250 @ A3

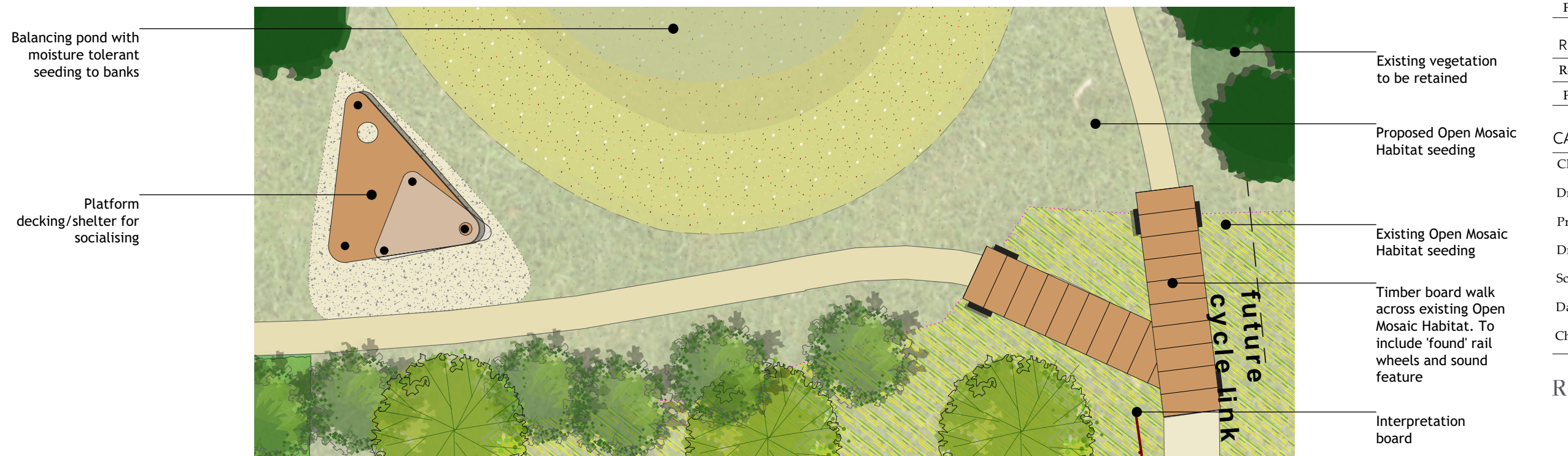

Balancing pond with moisture tolerant seeding to banks

Platform decking/shelter for socialising

Existing vegetation to be retained

Proposed Open Mosaic Habitat seeding

Existing Open Mosaic Habitat seeding

Timber board walk across existing Open Mosaic Habitat. To include 'found' rail wheels and sound feature

Interpretation board

P-2 Typical Play Areas- Wild Park  
 Scale 1:250 @ A3

