

KEY

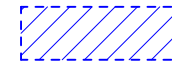

Extent of proposed underground root cells under hard surface
500 x 500 x 1200mm deep cells, supplied by Green Blue Urban or similar



Alternate over basements: Extent of proposed underground root cells under hard surface
500 x 500 x 600mm deep cells, supplied by Green Blue Urban or similar

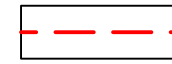

Basement extent

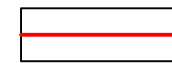

Site boundary

DO NOT SCALE FROM THIS DRAWING
TO BE READ IN COLOUR
Contractors, sub-contractors and suppliers are to verify any critical dimensions on site prior to commencing work, fabrication or construction of any elements. Any discrepancies or errors must be brought to the attention of Robert Myers Associates.
All structural elements are shown indicatively. For all elements of structure, refer to structural engineers' and specialist sub-contractor/fabricators' design, detail and specification.
The drawings are to be read in conjunction with all relevant landscape architect, consultant and specialist drawings.
This drawing is to be read specifically in conjunction with:
630_01(MP)008 Tree Strategy;
630_01(MP)011 Levels and Drainage;
630_01(MP)014 Attenuation strategy; and
630_01(CD)004 Rain Garden Kerb Detail.

LOCATION PLAN NTS

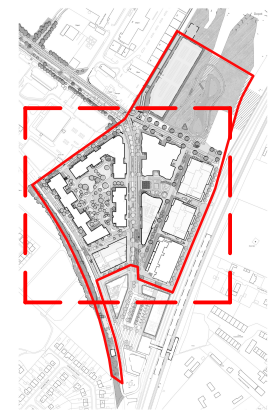

PURPOSE OF ISSUE

Rev:	Date:	Drawing Status:
P1	27.05.22	FOR PLANNING

REVISIONS

Rev:	Date:	Description:
P1	27.05.22	First Issue

CAMBRIDGE NORTH

Client:	Brookgate		
Drawing:	Root Cell Extents		
Project No:	630_01		
Drawing No:	630_01(MP)020		
Scale:	1:1500 @ A3	Rev:	P1
Date:	May 2022	Drawn:	EH
Checked:	JB	PM Checked:	RM

Robert Myers Associates
LANDSCAPE ARCHITECTURE

13-15 Covent Garden
Cambridge
CB1 2HS

Tel: +44 (0) 1223 351400

info@robertmyers-associates.co.uk
www.robertmyers-associates.co.uk

DO NOT SCALE FROM THIS DRAWING
© Robert Myers Associates

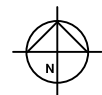
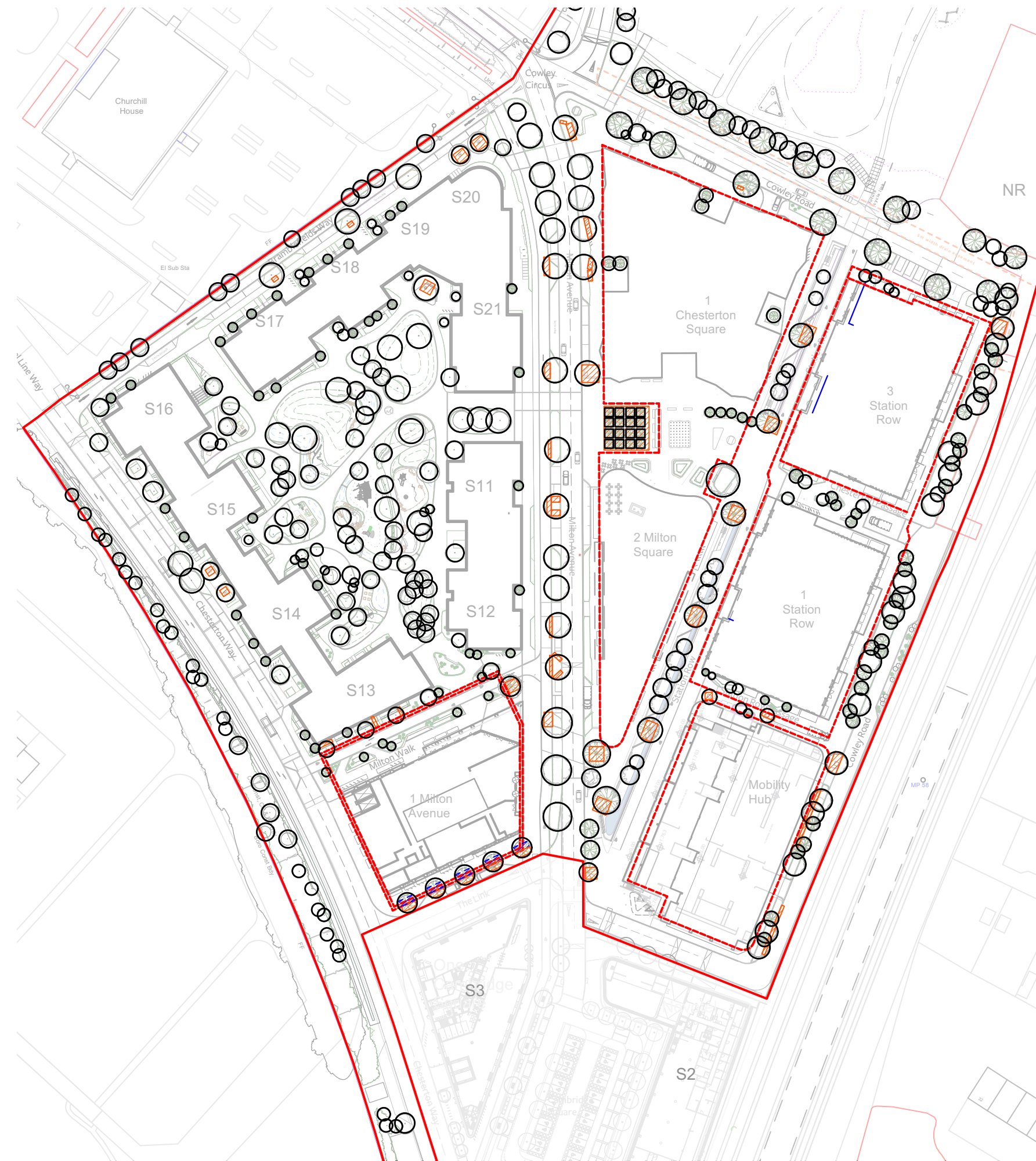

P-1

Root cell extents - Plan
Scale 1:1500 @ A3